

Simple Touch® 15-Channel Remote Aluminum Blind

- Installation and Care Instruction

1. Identify your aluminum blind and parts (your parts may vary, depending on the custom request & size of the blind you are purchasing.)

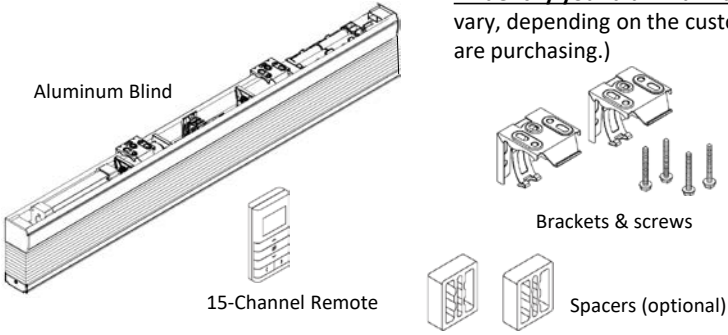

2. Tools you may need (not included)

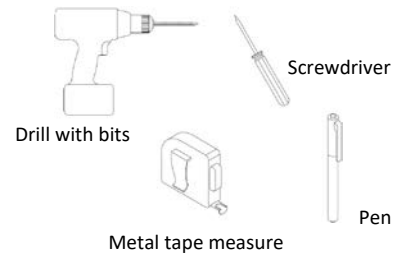

3. Install the brackets

- Mark the bracket locations. Space the brackets evenly and make sure the brackets will not interfere with any mechanism or other internal headrail parts.
- Install the brackets using screws (included) and tighten them completely.
- Make sure all brackets are aligned and level with each other.

- Install the blind with extension brackets (optional)
 - Install the extension bracket with at least 2 screws.
 - Attach the hidden brackets to the extension brackets with the screws.

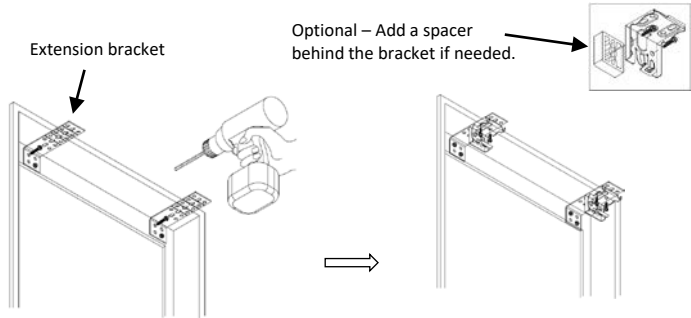
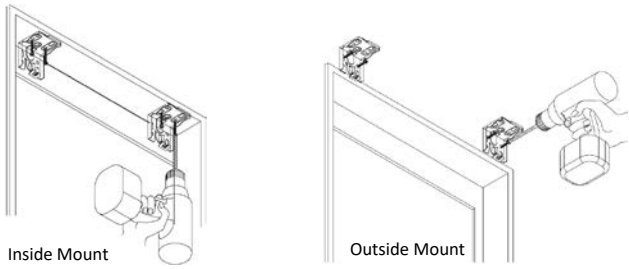

4. Put 8 Lithium AA batteries inside the battery box.

5. Mount the blind onto the brackets

6. Change the batteries.

Remove the blind from the brackets. Replace with new batteries (do not mix new batteries with used batteries. Mount the blind.

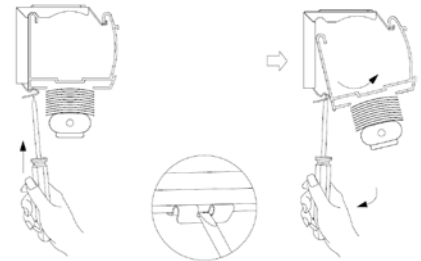
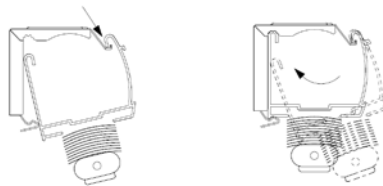
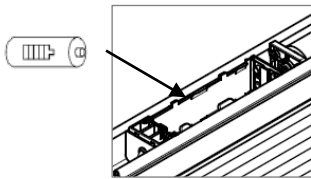

Care and Clean

- Wipe the blind periodically with a soft dust cloth or dusting mitt, or vacuum with a soft brush attachment.
- You may clean the blinds using a non-scratched sponge or dampened soft cloth with a mild nonabrasive detergent on the slats. Never use hot water, solvents, or harsh or abrasive cleansers to clean the blinds.

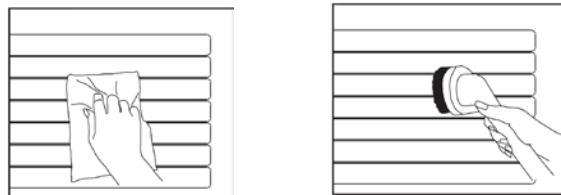

WARNING/ADVERTENCIA

Window blind cord can STRANGLE your child. To prevent strangulation, purchase cordless products or products with inaccessible cords.

La cuerda de la persiana puede ESTRANGULAR a su niño. Para evitar el estrangulamiento, compre alternativas cuerda o productos con cuerdas inaccesibles.

- Notes**
- Do not spill water to the headrail and the remote.
 - Do not clean/ operate the motorized blind with wet hands
 - The warranty for your blinds does not cover damage caused by improper cleaning.
 - Changing the batteries won't change the programming setting.



ID# 2AWSE-STP017WR15

Simple Touch® 15- Channel Remote Aluminum Blind

- Operation and Programming



This Simple Touch® motorized blind is already connected to the remote and programmed with Upper and Lower Limits. Option to program "My Favorite Position", follow the instruction below. Enjoy your new motorized blind!

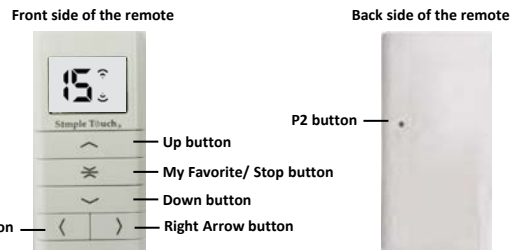

Features and Operation

FEATURES

- This Simple Touch® 15-channel remote works with 1" motorized aluminum blinds.
- Each channel can only control **ONE** motorized blind.
- Channel "0" is designed to control multiple blinds. The maximum controlled quantity is 15 blinds.

OPERATION

- Click **Left Arrow** () and **Right Arrow** () buttons to switch within channels.
- **Before set up My Favorite Position**
 - Press the **Up** () or **Down** () buttons to control the bottom rail go up or go down.
 - Click the **My Favorite/ Stop** () buttons to stop the moving of the blind.
- **After set up My Favorite Position** (please refer to the programming instruction below)
 - Press the **My Favorite** () button for 2 ~ 3 seconds and then release the button. The blind will go to My Favorite Position.
 - Press the **Up** () or **Down** () buttons for 1.5 seconds and then release the buttons. The blind will continue going up or going down.
 - Click the **My Favorite/ Stop** () button to stop the moving of the blind.

Programming Instruction (optional setup)

PROGRAMMING FOR MY FAVORITE POSITION

Set Up My Favorite Position



- Step 1. Click **Right Arrow** or **Left Arrow** buttons to select the channel. If you only have blind, please stay with channel "1".
- Step 2. Control the bottom rail to the favorite position by pressing **Up** or **Down** buttons.
- Step 3. Press **My Favorite** button for 5 seconds or until you hear a short "B".
- Step 4. Then press **My Favorite** button again for 3 seconds or until you hear 3 short "B".
- My Favorite Position** set up is done.

ADDING OR DELETING DUPLICATED REMOTE CONTROL

Add A Duplicated Remote Control

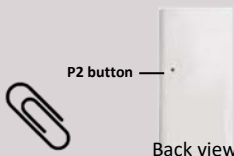

- Step 1. Click **P2** button with pin or paper clip on the back of the existing remote once. Then the blind **jogs** once.
- Step 2. Click the same **P2** button again, and then blind **jogs** once.
- Step 3. Click the **P2** button on the new remote, and then blind **jogs** once.
- Adding a duplicated remote** control is done.

Simple Touch® 15- Channel Remote Aluminum Blind

ADDING OR DELETING DUPLICATED REMOTE CONTROL (continued)

Delete A Duplicated Remote Control

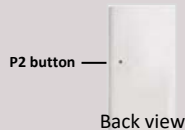

Step 1. Click the **P2** once on the remote you want to keep. Wait for the blind to “jog”.

Step 2. Click the same **P2** button again, and then wait for another jog.

Step 3. Click the **P2** button on the remote you want to delete.

Deleting a duplicated remote control is done.

TO REPROGRAM THIS MOTORIZED BLIND, PLEASE FOLLOW THE STEPS BELOW.

Restore factory setting

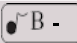
Press the **Up, My Favorite, and Down** buttons at the same time. Don't release until you hear a long “B”. 

Continue to follow the instruction below to set up **Frequency Connection, Upper Limit and Lower Limit**.

Frequency Connection (The RF Transmitter Module is inside of the headrail)

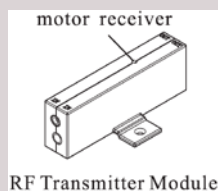

Step 1. Select the channel on the remote with clicking the **Left Arrow** and/ or **Right Arrow** buttons.

Step 2. Press the **Motor Receiver** button with a pin or a paper clip for 2 seconds, the motor jogs once, and then release the **Motor Receiver** button. 

Step 3. Click the **P2** button (on the back side of the remote) with a pin or a paper clip, and then wait for the motor to “jog”. 

Step 4. Click the **P2** button again and wait for another “jog”.

Step 5. Click the **Up** button (on the front side of the remote).

Frequency Connection completed.

Set Upper Limit

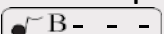

Step 1. Press the **Up** button to control the bottom rail going up.

Step 2. Press the **Up & My Favorite/ Stop** buttons at the same time for around 5 seconds until you hear 3 short “B”. 

Upper Limit set up is done.

Set Lower Limit



Step 1. Press the **Down** button to control the bottom rail moving down until it reaches the ordered drop height.

Step 2. Press the **Down & My Favorite/ Stop** buttons at the same time for around 5 seconds until you hear 3 short “B”. 

Lower Limit is done. Enjoy your motorized blind.

Program “My Favorite Position”, follow the instruction on page 1 as an option.

TO HIDE AND UNHIDE CHANNELS ON THE REMOTE (optional)

Hide Unused Channels On The Remote

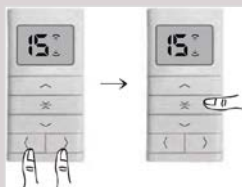

Step 1. Press and hold both **Left** and **Right** buttons at the same time until you see “C” and then “15” on the screen. Then release the buttons.

Step 2. Click the **Left** or **Right** button to select how many channels you want to keep on the remote. For example, if you have 5 motorized blinds connected to this remote, please select “5”.

Step 3. Press and hold the **My Favorite** button (a small square “□” will appear first) until the channel number is shown on the screen again.

Hide Unused Channels Setting is done.

Unhide Unused Channels On The Remote

Step 1. Press and hold both **Left** and **Right** buttons at the same time until you see “C” and then “15” on the screen. Then release the buttons.

Step 2. Press and hold the **My Favorite** button until a small square “□” is shown on the screen.

Unhide Setting is done.

Simple Touch® 15- Channel Remote Aluminum Blind



FCC ID# 2AWSE-STP017WR15

FOR INDOOR USE ONLY

This motorized blind has been tested and found to complete with the limits for a Class B digital device, pursuant to part 15 of the FCC rules. These limits are designed to provide reasonable protection against harmful interference in a residential installation. This blind generates, uses and can radiate radio-frequency energy. If this blind is not installed and used in accordance with the instructions, it may cause harmful interference to radio communications. However, there is no guarantee that interference will not occur in a particular installation. If this blind does cause harmful interference to radio or television reception, which can be determined by turning the blind off and on, correct the interference by one or more of the following measures:

Reorient or relocate the receiving antenna.

Increase separation between blind and receiver.

Connect equipment to an outlet on a circuit different from that to which the receiver is located.

Consult your dealer or an experienced radio/TV technician.

Any changes or modifications to the product that are not expressly approved by HT could void the user's authority to operate this blind. Use of a shielded interface cable is required to comply with the Class B limits of Part 15 of FCC rules. For more regulatory information, see the electronic user guide. HT shall not be liable for any direct, indirect, incidental, consequential, or other damage alleged in connection with the furnishing or use of this information.